

# REDCapCon 2018 Agenda



## Event Location:

Palmer House Hilton  
17 East Monroe Street  
Chicago, IL 60603

**Wifi network:** PH\_Meeting\_Room

**Username and password:** RED

## 'Con Informational Pages:

<https://tinyurl.com/redcapcon2018info>

## Connect:

[Find 'Con Social Activities on Community](#)



**Twitter** @projectredcap #redcapcon

Sunday, August 19, 2018 – Conference check-in, New Admin Workshop, Networking and Welcome Dinner		
Time	Location	Activity
<b>New Administrator Workshop</b>		
12:00 - 1:00 PM	4th Floor - State Ballroom	New Administrator Workshop attendee registration check-in
1:00 - 3:30 PM	4th Floor - Red Lacquer Ballroom	New Administrator Workshop (optional - must be pre-registered)
<b>Conference Registration, Networking, and Kickoff Dinner</b>		
2:00 - 4:00 PM	4th Floor - State Ballroom	Conference attendee registration check-in
	4th Floor - State Ballroom	Optional informal socializing/networking/meeting space – (unstructured - no refreshments provided)
4:15 PM	Street Level - Wabash Street Entrance	Group 1 Shuttle from hotel to pier ( <b>nametag required</b> , tag shows group #)
5:00 PM	Street Level - Wabash Street Entrance	Group 2 Shuttle from hotel to pier ( <b>nametag required</b> , tag shows group #)
6:00 - 9:00 PM	Spirit of Chicago River Cruise – <b>nametag required</b>	Welcome dinner (optional - must be pre-registered)
		<u>Welcome</u> - Julissa Acevedo, Sr. Business Systems Analyst/Univ. of Chicago <u>MVP Award Announcement</u> - Paul Harris - Professor, Biomedical Informatics/Vanderbilt University School of Medicine
9:30 PM	Back at hotel	Move to self-organized social activities
<b>Monday, August 20, 2018 – Conference check-in, Plenary, Workshops, Small Groups</b>		
7:00 - 8:15 AM	<b>Early 'Birds of a Feather' (optional ad hoc small groups)</b>	
	4th Floor - State Ballroom	Install a local REDCap instance (Bring your own laptop) <b>[a local REDCap instance is required if attending Coding session Tuesday PM]</b>
	4th Floor - Red Lacquer Ballroom	Collaborative space - available to reserve
7:30 – 8:25 AM	4th Floor - Registration Bays	Late conference check-in
	4th Floor - State Ballroom Foyer	Breakfast pickup (eat in Grand Ballroom)
<b>Plenary Sessions</b>		
8:25 - 9:00 AM	4th Floor - Grand Ballroom	<u>Welcome</u> <b>Julissa Acevedo, Sr. Business Systems Analyst/Univ. of Chicago</b> <u>Keynote</u> <b>Julian Solway - Dean for Translational Medicine and Director, Institute for Translational Medicine/Univ. of Chicago</b>
9:00 - 9:30 AM		<u>REDCap 2018: The Power of Us</u> <b>Paul Harris - Professor, Biomedical Informatics/Vanderbilt University School of Medicine</b>
9:30 - 10:15 AM		<u>REDCap Software: What's New &amp; What's Next</u> <b>Rob Taylor - Manager of Application Development/Vanderbilt University Medical Center</b>
10:15 - 10:30 AM	Break - State/Grand Foyer	
10:30 - 11:50 AM	4th Floor - Grand Ballroom	<u>Creative Uses of REDCap</u> <b>Bas de Veer - BMI Services Manager/University of Washington</b> <b>Jeff Hawley - IT Analyst, Sr./Duke University</b> <b>Amanda Miller - REDCap Administrator/University of Colorado</b>
11:55 AM - 1:00 PM	Lobby Level - Empire Room	Lunch buffet

# REDCapCon 2018 Agenda

Time	Location	Activity
<b>Monday, August 20, 2018 – Continued</b>		
<b>Workshops</b>		
1:00 - 2:30 PM	4th Floor - Grand Ballroom Tech	Plugins, Hooks and External Modules
	4th floor - State Ballroom Admin	MyCap
2:30 - 2:45 PM	Break - State/Grand Foyer	
2:45 - 4:15 PM	4th Floor - Grand Ballroom Tech	Epic Live Integration with REDCap
	4th Floor - State Ballroom Admin	Study Design Best Practices
4:15 - 4:30 PM	Break - State/Grand Foyer	
<b>Small Group Discussions</b>		
4:30 - 5:15 PM	4th Floor - Grand Ballroom Reporting	REDCap & R Reporting
	4th Floor - State Ballroom Feature	What's New, What's Next with the Mobile App
	4th Floor - Red Lacquer Ballroom New Administrator	Ask a REDCap Veteran/General Q&A
	3rd floor - Salon 3 Regulatory	Clinical Trials Validation, 21 CFR Part 11 Compliance
	3rd Floor - Salon 2 Committee/Group	Canadian Group
	3rd Floor - Salon 1	Collaborative space - available to reserve
5:15 PM	End of sessions - move to self-organized activities	
7:00 - 9:00 PM	3rd Floor - Crystal Room ( <b>Cash bar</b> )	Beer and Boardgames (Optional) - <b>Amanda Miller/Bas de Veer</b>
<b>Tuesday, August 21, 2018 – Plenary, Committee Fair, Breakout, and Poster Sessions</b>		
7:30 – 8:25 AM	4th Floor - Registration Bays	Late conference check-in
	4th Floor - State Ballroom Foyer	Breakfast pickup (eat in 4th Floor - Grand Ballroom)
<b>Plenary Sessions</b>		
8:25 - 8:30 AM	4th Floor - Grand Ballroom	<u>Welcome/housekeeping</u> <b>Stephany Duda</b> - Associate Professor, Biomedical Informatics/Vanderbilt University Medical Center
8:30 - 8:50 AM		<u>Plenary Presentation</u> <b>Firas Wehbe</b> -Chief Research Informatics Officer/Northwestern University
8:50 - 9:10 AM		<u>Using REDCap as a Clinical Tool</u> <b>Cristóbal Carvajal</b> - Physician & Director of Clinical Data Unit/Clinica Alemana de Santiago
9:10 - 9:30 AM		<u>Informatics and global health perspective</u> <b>Stephany Duda</b> - Associate Professor, Biomedical Informatics/Vanderbilt University Medical Center
9:30 - 9:50 AM		<u>Building Our Vision: Transforming Public Health Practice Using REDCap</u> <b>Sasha McGee</b> - Senior Infectious Disease Epidemiologist/D.C. Dept of Health
9:50 - 10:10 AM		<u>Design Flexibility, Recruitment, Retention: Keys to Supporting Grant-based Research</u> <b>Maxx Somers</b> - REDCap Program Manager/Cincinnati Children's
10:10 - 10:15 AM		Committees and Groups Fair Overview and Instructions
10:15 - 10:25 AM		Break & Committee Fair Setup
<b>Committee Fair - Instant Prize table</b>		
10:25 AM - 12:00 PM	4th Floor - Grand Ballroom	General games and other activities
10:25 AM - 12:00 PM	4th Floor - Exhibit Hall	Committee Tables
12:00 - 1:00 PM	Lobby Level - Empire Room	Lunch buffet

# REDCapCon 2018 Agenda

Time	Location	Activity
<b>Tuesday, August 21, 2018 – Continued</b>		
<b>Breakout Sessions</b>		
1:00 - 1:45 PM	4th Floor - Grand Ballroom Deep Dive	Smart Variables
	4th Floor - State Ballroom Admin	REDCap Administrative Support Models and User Policies
	4th Floor - Red Lacquer Ballroom Tech	External Modules Use Cases and Updates
1:45 - 2:00 PM	Break - State/Grand Foyer	
2:00 - 2:45 PM	4th Floor - Grand Ballroom Deep Dive	Maintaining and Updating REDCap Projects in Production
	4th Floor - State Ballroom Admin	Managing the use of REDCap Mobile App at Your Institution
	4th Floor - Red Lacquer Ballroom Tech	Scalability and Hosting
2:45 - 3:00 PM	Break - State/Grand Foyer	
3:00 - 3:45 PM	4th Floor - Grand Ballroom Deep Dive	Online Consenting
	4th Floor - State Ballroom Tech	I2B2, DDP, Cerner, FHIR and Other EHR Interoperability
	4th Floor - Red Lacquer Ballroom Admin	User Support & Training
<b>Poster Session</b>		
3:45 - 5:15 PM	4th Floor - Exhibit Hall	Poster session/competition/reception
5:15 PM	End of sessions - move to self-organized activities	
<b>'Night Owls' (optional ad hoc small groups)</b>		
6:00 - 9:00 PM	3rd Floor - Crystal Room ( <b>Cash bar</b> )	Beer and Coding: Hands-on External Module Development <b>Bring your own laptop: local instance of REDCap required (attend early bird session on Monday for assistance with setting up a local instance, if needed)</b>
5:15 - 9:00 PM	3rd Floor - Salon Rooms 1 & 2	Collaborative space - available to reserve
<b>Wednesday, August 22, 2018 – Walk/Run (optional), Small Groups and Plenary Sessions</b>		
6:30 - 8:00 AM	Hotel Lobby to Grant Park	~5k Fun Run/Walk
8:00 - 9:00 AM	4th Floor - State Foyer	Breakfast pickup
<b>Small Group Discussions</b>		
9:00 - 9:45 AM	4th Floor -Grand Ballroom New Administrator	Best Practices and Lessons Learned of How to Use REDCap
	4th Floor - State Ballroom Data Quality	REDCap and Data Standards
	4th Floor - Red Lacquer Ballroom Functionality	Repeating Forms/Events
	3rd Floor - Salon 3 Functionality	Randomization
	3rd Floor - Salon 2 Functionality	Twilio Use Cases
	3rd Floor - Salon 1 Committee/Group	Training Collaboration Committee
	3rd Floor - Salon 4 Committee/Group	Spanish Resources Group
9:45 - 10:00 AM	Break - State/Grand Foyer	
10:00 - 10:45 AM	4th Floor - Grand Ballroom (New Administrator)	Survey Deep Dive – Demos and Interesting Use Cases
	4th Floor - State Ballroom (Data Quality)	Data Quality
	4th floor - Red Lacquer Ballroom (Functionality)	Best Practices for Optimizing Data Dictionary Builds
	3rd Floor -Salon 3 (Tech)	Examples of Server setup
	3rd Floor - Salon 2 (Committee/Group)	FAQ
	3rd Floor - Salon Rooms 1 & 4	Collaborative space - available to reserve

# REDCapCon 2018 Agenda

Time	Location	Activity
<b>Wednesday, August 22, 2018 – Continued</b>		
<b>Small Group Discussions</b>		
10:45 - 11:00 AM	Break - State/Grand Foyer	
11:00 - 11:45 AM	4th Floor - Grand Ballroom	REDCap & Data Visualization Reporting
	4th Floor State Ballroom	Steps to Develop and Use API with an Example Tech
	4th Floor - Red Lacquer Ballroom	Operational/Non-Traditional Uses of REDCap New Administrator
	3rd Floor - Salon 3	Best Use of Action Tags Functionality
	3rd Floor - Salon 2	Regulatory & Software Validation Committee/Group
	3rd Floor - Salon 1	French Speaking Group Committee/Group
	3rd Floor - Salon Room 4	Collaborative space - available to reserve
12:00 - 12:50 PM	Lobby Level - Empire Room	
<b>Plenary Sessions</b>		
12:55 - 1:00 PM	4th Floor - Grand Ballroom	Door Prizes
1:00 - 1:20 PM		<u>Privacy-Preserving Data Collection in REDCap: A European Perspective</u> <b>Peter Brunecker and Michael Mallach</b> - Deputy Head of Research IT/Clinical Research Unit (CRU) / Berlin Institute
1:20 - 1:40 PM		<u>Bridging the Gap: REDCap and Health IT</u> <b>Adam Lee</b> - Research Informatics Specialist/University of North Carolina
1:40 - 2:00 PM		<u>REDCap at the Point-of-Care - Strategies and Solutions to Facilitate Research and Clinical Use of Patient-Reported Outcome Data</u> <b>Robert Schloesser - Executive Director</b> /Sheppard Pratt-Lieber Research Institute
2:00 - 2:20 PM		<u>Refactoring REDCap: Innovation for Sustainable Growth</u> <b>Andrew Martin</b> - Principal Informatics Architect/Stanford University
2:20 - 2:40 PM		<u>REDCap International Consortium: Local Initiatives towards Better Data for Better Health</u> <b>Katia da Silva</b> - Associate Professor, Department of Cardiopneumology/University of São Paulo Medical School
2:40 - 2:50 PM	Brief Break - 10 minutes	
2:50 - 2:55 PM	4th Floor - Grand Ballroom	Competition Winners Announced
2:55 - 3:15 PM		<u>Empowering Yourself and Your Team</u> <b>Paul Harris</b> - Professor, Biomedical Informatics/Vanderbilt University School of Medicine
3:15 - 3:25 PM		2019 REDCapCon Host Announcement
3:25 - 3:30 PM		Closing remarks and event dismissal

## 2018 REDCapCon Consortium Leadership and Support

### 2018 REDCapCon University of Chicago Hosts

Julissa Acevedo - Sr. Business Systems Analyst/University of Chicago  
Brian Furner - Director of Applications Development  
Julian Solway - Dean for Translational Medicine and Director, Institute for Translational Medicine/University of Chicago

### University of Chicago Onsite Conference Support

Tiffany Cyrus - Project Manager  
Kateland Haas - Informatics Cluster Program Manager  
Julie Johnson - Healthcare Business Analyst  
Stacie Landron - Healthcare Data Analyst  
Lois Vasquez - Executive Assistant

### Vanderbilt Conference Management Team

Veida Elliott - Senior Application Support Specialist  
Michelle Fernandez - Application Specialist  
Adam Lewis - Associate Application Specialist/Vanderbilt Institute for Clinical and Translational Research  
Laura McLeod - Relationship Manager  
Brenda Minor - REDCap Sr. Relationship Manager  
Lindsay O'Neal - IT Project Manager

### Small Group/Breakout/Workshop Session Coordinators

Jeff Hawley - IT Analyst, Sr./Duke University  
Laura McLeod - Relationship Manager/Vanderbilt Institute for Clinical and Translational Research  
Lynn Simpson - Enterprise Research Applications Manager/Harvard Catalyst - Partners HealthCare  
Fontayne Wong - Data Management Coordinator/BC Children's Hospital Research Institute

### Workshop Leaders

#### New Administrator Workshop

Andy Arenson - Principal Programmer/Analyst/Indiana University  
Sean Banks - Data Scientist/Ascension  
Heidi Beard - REDCap Administrator/Spectrum Health Hospital  
Linda Carlin - Senior Professional Research Assistant/University of Colorado Denver  
Bas de Veer - BMI services manager/University of Washington - Biomedical Informatics Core  
Leila Deering - Application Analyst Senior/Marshfield Clinic Research Institute  
Michelle Fernandez - Application Specialist/Vanderbilt Institute for Clinical and Translational Research  
Ruthie Knowles - REDCap Administrator/National Jewish Health  
Jason Lones - Sr. IT Analyst/Duke University  
Amanda Miller - REDCap Administrator/University of Colorado Denver | Anschutz Graduate School  
Clarence Potter - Clinical Data Manager/University of North Carolina  
Joe Wick - Principal Business Analyst/Mayo Clinic

#### Plugins, Hooks and External Modules

Veida Elliott - Senior Application Support Specialist/Vanderbilt Institute for Clinical and Translational Research  
Chris Kadolph - Software Development Team Lead - Technical/Marshfield Clinic Research Institute  
Adam Lewis - Associate Application Specialist/Vanderbilt Institute for Clinical and Translational Research  
Jason Lones - Sr. IT Analyst/Duke University  
Andrew Martin - Principal Informatics Architect/Stanford University  
Kyle McGuffin - Mgr Application Development/Vanderbilt Institute for Clinical and Translational Research

#### MyCap

Leila Deering - Application Analyst Senior/Marshfield Clinic Research Institute  
Amy Drake - Sr. Business System Analyst/Ohio State University  
Jonathan Swafford - Sr. Application Developer/Vanderbilt Institute for Clinical and Translational Research

#### Epic Live Integration with REDCap

Teresa Bosler - Information Resources Manager/University of Texas Southwestern Medical Center at Dallas  
Jeff Hawley - IT Analyst, Sr./Duke University  
Lindsay O'Neal - IT Project Manager /Vanderbilt Institute for Clinical and Translational Research  
Rob Taylor - Mgr of Application Development/Vanderbilt Institute for Clinical and Translational Research

#### Study Design Best Practices

Andy Arenson - Principal Programmer/Analyst/Indiana University  
Catherine Bauer-Martinez - REDCap Application Administrator/Indiana University  
Leila Deering - Application Analyst Senior/Marshfield Clinic Research Institute  
Amy Drake - Sr. Business System Analyst/Ohio State University

## 2018 REDCapCon Consortium Leadership and Support

### Breakout Session Leaders

#### Smart Variables

Will Beasley - University of Oklahoma - Health Sciences Center

Rob Taylor - Mgr of Application Development/Vanderbilt Institute for Clinical and Translational Research

#### REDCap Administrative Support Models and User Policies

Linda Carlin - Senior Professional Research Assistant/University of Colorado Denver

Philip Chase - Assistant Director/University of Florida - CTSI

Amy Drake - Sr. Business System Analyst/Ohio State University

Brenda Minor - REDCap Sr. Relationship Manager/Vanderbilt Institute for Clinical and Translational Research

#### External Modules Use Cases and Updates

Chris Kadolph - Software Development Team Lead - Technical/Marshfield Clinic Research Institute

Adam Lewis - Associate Application Specialist/Vanderbilt Institute for Clinical and Translational Research

Jason Lones - Sr. IT Analyst/Duke University

Andrew Martin - Principal Informatics Architect/Stanford University

Kyle McGuffin - Mgr Application Development/Vanderbilt Institute for Clinical and Translational Research

Lindsay O'Neal - IT Project Manager /Vanderbilt Institute for Clinical and Translational Research

#### Maintaining and Updating REDCap Projects in Production

Leila Deering - Application Analyst Senior/Marshfield Clinic Research Institute

Naveen Karduri - Lead Programmer/BC Children's Hospital Research Institute

Ashleigh Lewis - REDCap Administrator/University of Washington - Biomedical Informatics Core

Paul Litwin - Programming Core Manager/Fred Hutchinson Cancer Research Center

Suzanne McCahan - Assistant Research Scientist/Alfred I DuPont Hospital for Children of the Nemours Foundation

Shalini Saini - System Analyst Sr/University of Alabama at Birmingham - Department of Medicine

#### Managing the use of REDCap Mobile App at Your Institution

Giovanni Delacqua - Application Developer/Vanderbilt Institute for Clinical and Translational Research

Amy Drake - Sr. Business System Analyst/Ohio State University

Michelle Fernandez - Application Specialist/Vanderbilt Institute for Clinical and Translational Research

Amanda Miller - REDCap Administrator/University of Colorado Denver | Anschutz Graduate School

Lynn Simpson - Enterprise Research Applications Manager/Harvard Catalyst - Partners HealthCare

#### Scalability and Hosting

Will Beasley - University of Oklahoma - Health Sciences Center

Philip Chase - Assistant Director/University of Florida - CTSI

Dimitar Dimitrov - Software Engineer/Harvard Catalyst - Partners HealthCare

Adam Lee - Research Informatics Specialist/University of North Carolina

#### Online Consenting

Suzanne McCahan - Assistant Research Scientist/Alfred I DuPont Hospital for Children of the Nemours Foundation

Stephanie Oppenheimer - REDCap Administrator/Medical University of South Carolina

Lynn Simpson - Enterprise Research Applications Manager/Harvard Catalyst - Partners HealthCare

Marissa Stroo - Director, Clinical Research Operations - Data/Duke University

#### I2B2, DDP, Cerner, FHIR and Other EHR Interoperability

Teresa Bosler - Information Resources Manager/University of Texas Southwestern Medical Center at Dallas

Chris Kadolph - Software Development Team Lead - Technical/Marshfield Clinic Research Institute

Adam Lee - Research Informatics Specialist/University of North Carolina

Alexander Maclay - Research Electronic Data Coordinator/Sheppard Pratt-Lieber Research Institute, Inc.

Shalini Saini - System Analyst Sr/University of Alabama at Birmingham - Department of Medicine

#### User Support & Training

Leila Deering - Application Analyst Senior/Marshfield Clinic Research Institute

Amy Drake - Sr. Business System Analyst/Ohio State University

Amanda Miller - REDCap Administrator/University of Colorado Denver | Anschutz Graduate School

### Ad Hoc Small Groups (Early Reservations)

#### Install a Local REDCap Instance

Pravina Kota - IT Analyst/University of Oklahoma - Health Sciences Center

Brian Main - Database Analyst/Eastern Virginia Medical School - Leroy T. Canoles Jr. Cancer Research Center

Greg Neils - Developer and Data Manager/Columbia University Medical Center - Data Coordinating Center

Jeff Witzel - Director of IT/Burn Data Center - University of Washington

## 2018 REDCapCon Consortium Leadership and Support

### Ad Hoc Small Groups (Early Reservations) - Continued

#### Beer and Coding: Hands-on External Module Development

Chris Kadolph - Software Development Team Lead - Technical/Marshfield Clinic Research Institute

Jason Lones - Sr. IT Analyst/Duke University

Andrew Martin - Principal Informatics Architect/Stanford University

Kyle McGuffin - Mgr Application Development/Vanderbilt Institute for Clinical and Translational Research

#### Small Group Discussion Leaders

##### REDCap & R Reporting

Theresa Baker - REDCap Specialist/Cincinnati Children's Hospital Medical Center

Will Beasley - University of Oklahoma - Health Sciences Center

Alexander Maclay - Research Electronic Data Coordinator/Sheppard Pratt-Lieber Research Institute, Inc.

Eduardo Morales - REDCap Administrator/New England Baptist Hospital

Shang Wei - University of California, Davis

##### What's New, What's Next with the Mobile App

Giovanni Delacqua - Application Developer/Vanderbilt Institute for Clinical and Translational Research

Michelle Fernandez - Application Specialist/Vanderbilt Institute for Clinical and Translational Research

##### Ask a REDCap Veteran/General Q&A

Jeremy Alphonse - EDC Project Analyst/Harvard Catalyst - Partners HealthCare

Andy Arenson - Principal Programmer/Analyst/Indiana University

Jeff Hawley - IT Analyst, Sr./Duke University

Brian Main - Database Analyst/Eastern Virginia Medical School - Leroy T. Canoles Jr. Cancer Research Center

Suzanne McCahan - Assistant Research Scientist/Alfred I DuPont Hospital for Children of the Nemours Foundation

Chris Motteler - REDCap Administrator/East Carolina University

Liz Moyer - REDCap Team Lead/Oregon Health & Science University

David Rogers - Software Developer/Fred Hutchinson Cancer Research Center

##### Clinical Trials Validation, 21 CFR Part 11 Compliance

Amy Drake - Sr. Business System Analyst/Ohio State University

Lindsay O'Neal - IT Project Manager /Vanderbilt Institute for Clinical and Translational Research

Lynn Simpson - Enterprise Research Applications Manager/Harvard Catalyst - Partners HealthCare

##### Canadian Group

Victor Espinosa - Data Manager/Vancouver Island Health Authority

Naveen Karduri - Lead Programmer/BC Children's Hospital Research Institute

Rick Watts - Team Lead, Research Informatics/University of Alberta

Fontayne Wong - Data Management Coordinator/BC Children's Hospital Research Institute, a program of the Provincial Health Services Authority

##### Best Practices and lessons learned of how to use REDCap

Leila Deering - Application Analyst Senior/Marshfield Clinic Research Institute

Brian Main - Database Analyst/Eastern Virginia Medical School - Leroy T. Canoles Jr. Cancer Research Center

Suzanne McCahan - Assistant Research Scientist/Alfred I DuPont Hospital for Children of the Nemours Foundation

Greg Neils - Developer and Data Manager/Columbia University Medical Center - Data Coordinating Center

##### REDCap and Data Standards

Amy Drake - Sr. Business System Analyst/Ohio State University

Adam Lee - Research Informatics Specialist/University of North Carolina

##### Repeating Forms/Events

Paul Litwin - Programming Core Manager/Fred Hutchinson Cancer Research Center

Lindsay O'Neal - IT Project Manager /Vanderbilt Institute for Clinical and Translational Research

Shalini Saini - System Analyst Sr/University of Alabama at Birmingham - Department of Medicine

##### Randomization

Veida Elliott - Senior Application Support Specialist/Vanderbilt Institute for Clinical and Translational Research

Jeff Hawley - IT Analyst, Sr./Duke University

Joe Wick - Principal Business Analyst/Mayo Clinic

##### Twilio Use Cases

Roseline Antai - Postdoctoral Researcher/University of Edinburgh

Audrey Brown - Data Manager III/NIH/NIEHS

Gary Rains - Analyst Programmer II/Duke University

David Rogers - Software Developer/Fred Hutchinson Cancer Research Center

Maxx Somers - REDCap Program Manager/Cincinnati Children's Hospital Medical Center

## 2018 REDCapCon Consortium Leadership and Support

### Small Group Discussion Leaders - continued

#### Training Collaboration Committee

Catherine Bauer-Martinez - REDCap Application Administrator/Indiana University  
Alisa Garcia - IT Business Systems Analyst/ARUP Laboratories (Associated Regional & University Pathologists)  
Ashleigh Lewis - REDCap Administrator/University of Washington - Biomedical Informatics Core  
Rupinder Mann - Research Informatics Program Manager/Lawson Health Research Institute  
Liz Moyer - REDCap Team Lead/Oregon Health & Science University  
Taryn Stoffs - REDCap Support Team Lead/University of Florida - CTSI

#### Spanish Resources Group

Victor Espinosa - Data Manager/Vancouver Island Health Authority  
Michelle Fernandez - Application Specialist/Vanderbilt Institute for Clinical and Translational Research  
Eduardo Morales - REDCap Administrator/New England Baptist Hospital

#### Survey deep dive – demos and interesting use cases

Leila Deering - Application Analyst Senior/Marshfield Clinic Research Institute  
Amy Drake - Sr. Business System Analyst/Ohio State University  
Naveen Karduri - Lead Programmer/BC Children's Hospital Research Institute  
Suzanne McCahan - Assistant Research Scientist/Alfred I DuPont Hospital for Children of the Nemours Foundation  
Liz Moyer - REDCap Team Lead/Oregon Health & Science University  
Andrew Ready - Electronic Data Coordinator/Sheppard Pratt-Lieber Research Institute, Inc.

#### Data Quality

Veida Elliott - Senior Application Support Specialist/Vanderbilt Institute for Clinical and Translational Research  
Ruthie Knowles - REDCap Administrator/National Jewish Health  
Rick Watts - Team Lead, Research Informatics/University of Alberta  
Shang Wei - University of California, Davis

#### Best Practices for Optimizing Data Dictionary Builds

Jeff Hawley - IT Analyst, Sr./Duke University  
Laura McLeod - Relationship Manager/Vanderbilt Institute for Clinical and Translational Research  
David Rogers - Software Developer/Fred Hutchinson Cancer Research Center

#### Examples of Server setup

Dimitar Dimitrov - Software Engineer/Harvard Catalyst - Partners HealthCare  
Brian Main - Database Analyst/Eastern Virginia Medical School - Leroy T. Canoles Jr. Cancer Research Center  
Seton McRae - Sr. BI Applications Analyst/Children's Healthcare of Atlanta  
Eduardo Morales - REDCap Administrator/New England Baptist Hospital

#### FAQ

Bas de Veer - BMI services manager/University of Washington - Biomedical Informatics Core  
Amanda Miller - REDCap Administrator/University of Colorado Denver | Anschutz Graduate School

#### REDCap & Data Visualization

Will Beasley - University of Oklahoma - Health Sciences Center  
Cristóbal Carvajal - Physician & Director of Clinical Data Unit/Clinica Alemana de Santiago  
Victor Espinosa - Data Manager/Vancouver Island Health Authority  
Liz Moyer - REDCap Team Lead/Oregon Health & Science University  
David Rogers - Software Developer/Fred Hutchinson Cancer Research Center

#### Steps to develop and use API with an example

Rick Church - Senior Analyst, Research Applications/NYU Langone Health  
Naveen Karduri - Lead Programmer/BC Children's Hospital Research Institute  
Adam Lee - Research Informatics Specialist/University of North Carolina  
Eduardo Morales - REDCap Administrator/New England Baptist Hospital

#### Operational/non-traditional uses of REDCap

Leila Deering - Application Analyst Senior/Marshfield Clinic Research Institute  
Amy Drake - Sr. Business System Analyst/Ohio State University  
Chris Kadolph - Software Development Team Lead - Technical/Marshfield Clinic Research Institute  
Denise Snyder - Associate Dean for Clinical Research/Duke University  
Fontayne Wong - Data Management Coordinator/BC Children's Hospital Research Institute

#### Best use of action tags

Bas de Veer - BMI services manager/University of Washington - Biomedical Informatics Core  
Amanda Miller - REDCap Administrator/University of Colorado Denver | Anschutz Graduate School  
Lindsay O'Neal - IT Project Manager /Vanderbilt Institute for Clinical and Translational Research



## 2018 REDCapCon Consortium Leadership and Support

### Small Group Discussion Leaders - continued

#### Regulatory & Software Validation

Kim Gajewski - Database Administrator/Medical College of Wisconsin  
Greg Kopoian - Systems Administrator/Population Health Research Institute  
Stephanie Oppenheimer - REDCap Administrator/Medical University of South Carolina  
Shang Wei - University of California, Davis

#### French Speaking Group

Benjamin Dupont - Project manager/Institut Pasteur  
Marie Sanchez - Data Manager/Institut Pasteur

#### Committee Fair Coordinators

Michelle Fernandez - Application Specialist/Vanderbilt Institute for Clinical and Translational Research  
Amanda Miller - REDCap Administrator/University of Colorado Denver | Anschutz Graduate School

#### Committee Fair Table Attendants

#### FAQ

Andy Arenson - Principal Programmer/Analyst/Indiana University  
Bas de Veer - BMI services manager/University of Washington - Biomedical Informatics Core  
Jeff Hawley - IT Analyst, Sr./Duke University  
Amanda Miller - REDCap Administrator/University of Colorado Denver | Anschutz Graduate School

#### REDLOC

Robert Geller - IT Project Manager/University of Texas Health Science Center at San Antonio  
Amanda Miller - REDCap Administrator/University of Colorado Denver | Anschutz Graduate School  
Mei Xue - Database Analyst/University of Utah

#### Training Collaboration Committee

Catherine Bauer-Martinez - REDCap Application Administrator/Indiana University  
Rani Dalgin - REDCap Administrator/Boston College  
Alisa Garcia - IT Business Systems Analyst/ARUP Laboratories (Associated Regional & University Pathologists)  
Ashleigh Lewis - REDCap Administrator/University of Washington - Biomedical Informatics Core  
Rupinder Mann - Research Informatics Program Manager/Lawson Health Research Institute  
Stephanie Oppenheimer - REDCap Administrator/Medical University of South Carolina  
Taryn Stoffs - REDCap Support Team Lead/University of Florida - CTSI

#### Spanish Resources Group

Victor Espinosa - Data Manager/Vancouver Island Health Authority  
Eduardo Morales - REDCap Administrator/New England Baptist Hospital

#### Regulatory and Software Validation

Teresa Bosler - Information Resources Manager/University of Texas Southwestern Medical Center at Dallas  
Kim Gajewski - Database Administrator/Medical College of Wisconsin  
Viswa Gopinath - Applications Analyst II/Icahn School of Medicine at Mount Sinai  
Jen Hoitenga - Programmer/Analyst II/Children's Mercy Hospital  
Stephanie Oppenheimer - REDCap Administrator/Medical University of South Carolina  
Shalini Saini - System Analyst Sr/University of Alabama at Birmingham - Department of Medicine

#### Committee Fair General Activities Volunteers

Theresa Baker - REDCap Specialist/Cincinnati Children's Hospital Medical Center  
Tasha Coughlin - Data Manager/Boston University - CTSI  
Amy Drake - Sr. Business System Analyst/Ohio State University  
Diantha Howard - Informatics Specialist/University of Vermont  
Heather Lansky - Biomedical Informatics Consultant/Ohio State University  
Adam Lee - Research Informatics Specialist/University of North Carolina  
Adam Lewis - Associate Application Specialist/Vanderbilt Institute for Clinical and Translational Research  
Suzanne McCahan - Assistant Research Scientist/Alfred I DuPont Hospital for Children of the Nemours Foundation  
Laura McLeod - Relationship Manager/Vanderbilt Institute for Clinical and Translational Research  
Shana Rimmer - Research Informatics Specialist /University of Alberta

### Poster # Poster Presenters

#### 1 Health Information Exchange in REDCap

Leila Deering - Application Analyst Senior/Marshfield Clinic Research Institute  
Chris Kadolph - Software Development Team Lead - Technical/Marshfield Clinic Research Institute

## 2018 REDCapCon Consortium Leadership and Support

Poster #	Poster Presenters - continued
2	<b>REDCap-ETL: Automating data workflows and accelerating research</b> Andy Arenson - Principal Programmer/Analyst/Indiana University Catherine Bauer-Martinez - REDCap Application Administrator/Indiana University Abhueet Malatpure - Principal Systems Analyst/Indiana University Jim Mullen - Principal Systems Analyst/Indiana University
3	<b>REDCap External Module - Form Render Skip Logic</b> Taryn Stoffs - REDCap Support Team Lead/University of Florida - CTSI
4	<b>Experiences in running an offline electronic data capture system in a large-scale population trial in Nepal and Bangladesh</b> Yama Ghulam Farooq - Clinical Trials IT Manager/University of Oxford
5	<b>Implementation of a highly secure REDCap infrastructure that retains world-wide survey capabilities</b> Naveen Karduri - Lead Programmer/BC Children's Hospital Research Institute
6	<b>The Ever-Expanding Functions of REDCap - Successfully Administrating Investigator-Initiated Research Studies</b> Hope Kincaid and Jennifer Macfarlan - Biostatistician/Lehigh Valley Health Network
7	<b>Let Your PIs Manage the Expiration Date</b> Paul Blue - University of North Carolina Jinhee Pae - Research Applications Developer/University of North Carolina
8	<b>Using REDCap to Stop the Data Chaos</b> Roya Hamadani - Data Coordinator/Lehigh Valley Health Network
9	<b>An integrated toolbox to collect and deliver clinically-relevant information on-demand</b> Fontayne Wong - Data Management Coordinator/BC Children's Hospital Research Institute
10	<b>REDCap at Institut Pasteur, illustrated by a use case with offline constraints</b> Benjamin Dupont - Project manager/Institut Pasteur Marie Sanchez - Data Manager/Institut Pasteur
11	<b>An Interactive Multimedia Consent Process Using a Website and Videos</b> Suzanne McCahan - Assistant Research Scientist/Alfred I DuPont Hospital for Children of the Nemours Foundation
12	<b>A Linear Data Entry Workflow for REDCap and the WARRIOR Investigation</b> Philip Chase - Assistant Director/University of Florida - CTSI
13	<b>Creative REDCap Integration Projects</b> Adie Fridman - Applications Specialist I/Cedars-Sinai Medical Center Edward Kowalewski - Application Specialist I/Cedars-Sinai Medical Center
14	<b>Building a multi-language enrollment and data collection app in REDCap for a Family Strengthening Intervention trial for refugee families in New England with refugee research collaborators</b> Peter MacIsaac - Victorian Agency for Health Information
15	<b>Improving Patient Enrollment Process using REDCap and HIE</b> Rajani Julooru - Sr Application Analyst/Feinstein Institute of Medical Research, Northwell Health Darshan Shinde - Computer Systems Analyst/ Solutions Architect/Feinstein Institute of Medical Research, Northwell Health
16	<b>Design of a Virtual Research Environment for Adrenal Research</b> Manuel Schulze - Research Associate/Technische Universität Dresden
17	<b>Optimizing REDCap for a longitudinal multi-site medical research project (cancer registry) in Australia</b> John Liman - REDCap Administrator/Monash University
18	<b>REDCap Admin Dashboard</b> Eric Neuhaus - University of Iowa
19	<b>Bridging the Communication Gap with the Holistic REDCap Human Subject Toolbox for Research Institutions</b> Theresa Baker - REDCap Specialist/Cincinnati Children's Hospital Medical Center
20	<b>Supporting Clinical Processes and Clinical Research for Autism Patients and the Kansas Intellectual and Developmental Disabilities Research Center (KIDDRC) via REDCap</b> Angelica Allen - Clinical Information Specialist/University of Kansas Medical Center - Medical Informatics
21	<b>Diseases Registries &amp; REDCap at KFSH&amp;RC Epilepsy Registry - Example.</b> Saleh Al Ageel - Senior Technical Specialist/King Faisal Specialist Hospital and Research Centre
22	<b>CTSI Pilot Management System</b> Mark Oium - Programmer Analyst/Medical College of Wisconsin
Poster #	<b>Non-competing</b>
23	<b>Crowd-sourcing surgical data</b> Roseline Antai - Postdoctoral Researcher/University of Edinburgh
24	<b>For women who are positive for human immunodeficiency virus and children who are born, Integration of clinical information and construction of follow-up system using REDCap</b> Koji Kitajima - Senior Research Scientist/National Center for Global Health and Medicine - JCRAC Data Center

# THIRD

floor  
SALONS

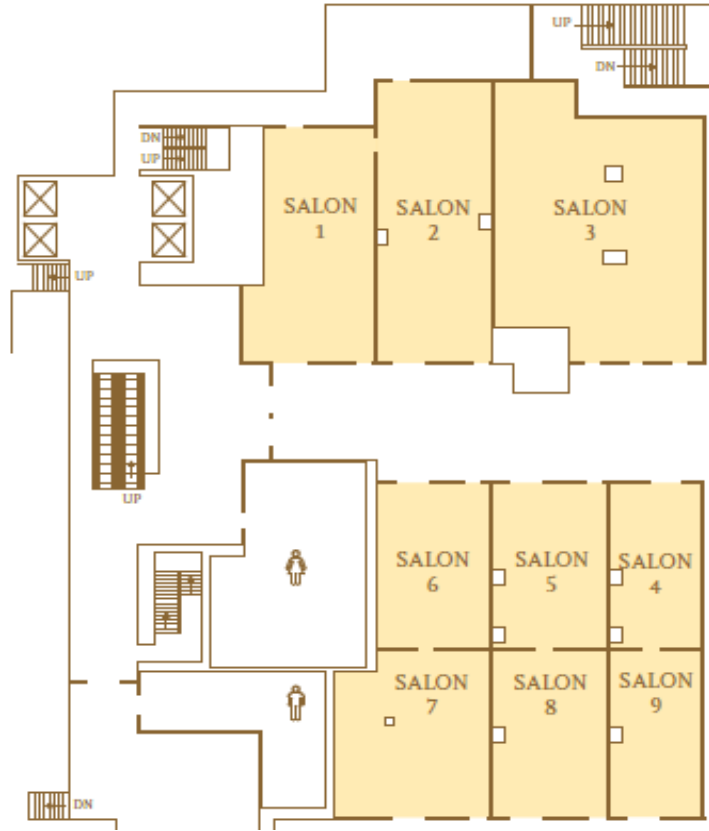

# FOURTH

floor

